

10 581 300 00 EUPHORIA PUREFOAM SHOWER SYSTEM WITH THERMOSTAT FOR WALL MOUNTING

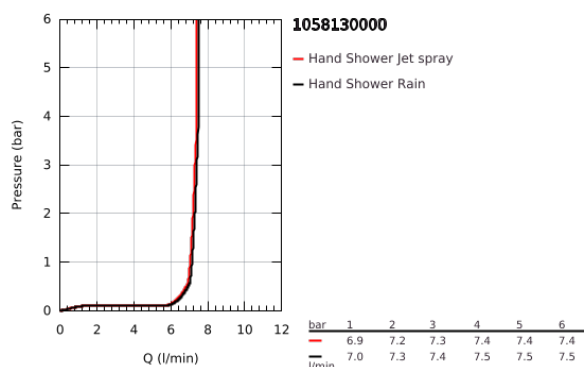
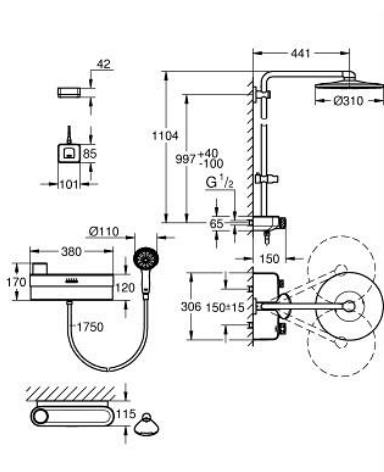

PRODUCT DESCRIPTION

- Colour: chrome
- consisting of:
- GROHE Purefoam device in white with glass top cover
- including lithium-ion rechargeable battery (103385), charger with power plug Type C (103384) and Type G (103386) and soaps starter kit (fragrances: Mint 250 ml, Marine 2 x 250 ml, Citrus 2 x 250 ml, Blossom 2 x 250 ml, Water lily 2 x 250 ml)
- GROHE Purefoam - enveloping shower experience with instant warm foam
- Euphoria SmartControl system 310 Duo
- including horizontal 450 mm shower arm
- upper bracket adjustable for minimal adaption to existing drilling holes
- exposed SmartControl thermostat with integrated GROHE EasyReach shower tray
- allows change between:
- head shower Rainshower SmartActive 310, 2 spray patterns: GROHE PureRain, ActiveRain, and hand shower
- GROHE Purefoam 110 hand shower 2 sprays (Rain, Jet) with white sprayface (107 298)
- Silverflex shower hose 1250 mm (28 362)
- Silverflex shower hose 1750 mm 1/2" x 1/2" (28 388 000)
- maximum flow rate (at 3 bar): 16 l/min
- GROHE Purefoam device suitable for screwing (including screws and dowels) or gluing (glue 40 915 000 sold separately - 4 x needed)
- holding force: max. 5 kg
- the specified holding capacity is valid for static (slowly applied) load and intended use only

10 581 300 00 EUPHORIA PUREFOAM SHOWER SYSTEM WITH THERMOSTAT FOR WALL MOUNTING

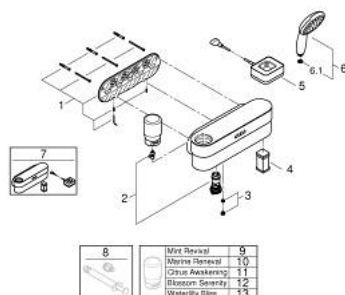

SPARE PARTS, January 2024 – now

- 1: Fixing set (Order-nr. 107444K000)
- 2: Filter set (Order-nr. 107442LN00)
- 3: Flow restrictor + inlet filter (Order-nr. 1074439990)
- 4: Battery (Order-nr. 1033859990)
- 5: Charger (Order-nr. 1033849990)
- 6: Hand shower 2 sprays (Order-nr. 1072980000)
- 6.1: Strainer (Order-nr. 0700200M)
- 7: Exchange device (Order-nr. 107445LN00)
- 8: Glue for bath accessories (Order-nr. 40915000)*
- 9: Foaming body soap Mint/refreshing (Order-nr. 1033699990)*
- 10: Foaming body soap Marine/moisturizing (Order-nr. 1033809990)*
- 11: Foaming body soap Citrus/invigorating (Order-nr. 1033819990)*
- 12: Foaming body soap Blossom/nourishing (Order-nr. 1033829990)*
- 13: Foaming body soap Water lily/calming (Order-nr. 1033839990)*

*Special accessories