

19 450 002 EUROSMART SINGLE-LEVER BATH/SHOWER MIXER TRIM

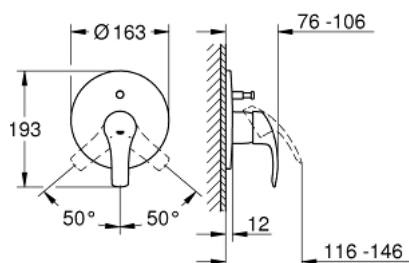

PRODUCT DESCRIPTION

- Colour: chrome
- set for final installation for
- 33 961 000, 33 963 000, 33 965 000
- without concealed body
- metal lever
- GROHE Long-Life finish
- GROHE FastFixation covered fixing
- automatic diverter: bath/shower
- escutcheon- and shaft-sealing
- metal wall escutcheon



19 450 002 EUROSMART SINGLE-LEVER BATH/SHOWER MIXER TRIM



SPARE PARTS, October 2013 – now

- 1: Lever (Order-nr. 46903000)
- 2: Escutcheon (Order-nr. 46905000)
- 3: Diverter (Order-nr. 46737000)
- 4: Temperature limiter (Order-nr. 46308000)*
- 5: Extension set (Order-nr. 46191000)*
- 6: Extension set (Order-nr. 46343000)*

*Special accessories