

## 21 375 001 **COSTA L BASIN MIXER, 1/2"**

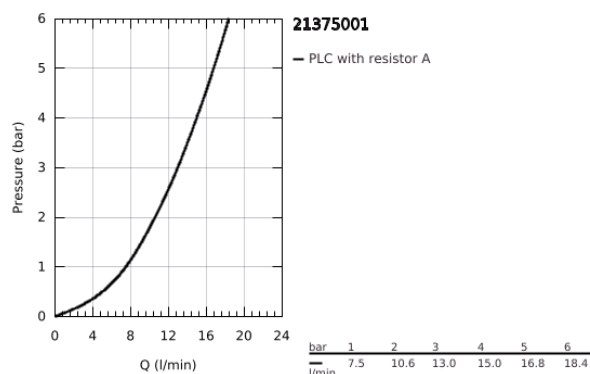

### PRODUCT DESCRIPTION

- Colour: chrome
- metal handles
- heat-insulated
- screwable
- GROHE Long-Life headpart
- swivel tubular spout with mousseur
- pop-up waste set 1 1/4"
- flexible connection hoses
- GROHE Long-Life finish



## 21 375 001 **COSTA L BASIN MIXER, 1/2"**

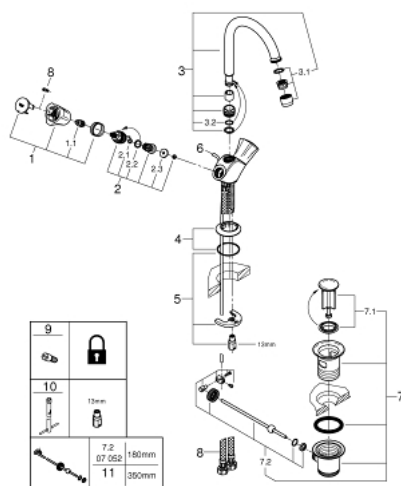

### SPARE PARTS, July 2018 – now

- 1: Handle (Order-nr. 45994000)
- 1.1: Snap insert (Order-nr. 0538600M)
- 2: Headpart 1/2" (Order-nr. 07146000)
- 2.1: O-Ring Ø6 x Ø2 (Order-nr. 0128300M)
- 2.2: O-Ring Ø18,2 x Ø1,7 (Order-nr. 0392400M)
- 2.3: Sealing washer (Order-nr. 0529100M)
- 3: Biflo spout (Order-nr. 13219000)
- 3.1: Flow restrictor (Order-nr. 13928000)
- 3.2: O-ring dia. 12x2 mm (Order-nr. 0128000M)
- 4: Escutcheon (Order-nr. 48004000)
- 5: Shank fastening assembly (Order-nr. 46249000)
- 6: Lift rod (Order-nr. 65936PD0)
- 7: Pop-up waste set 1 1/4" (Order-nr. 28910000)
- 7.1: Chrome bath plug (Order-nr. 07182000)
- 7.2: Eccentric rod (Order-nr. 07052000)
- 8: Connection hose (Order-nr. 46255000)
- 9: Screw for Costa/Avina products (Order-nr. 48013000)\*
- 10: Mounting wrench (Order-nr. 19017000)\*
- 11: Eccentric rod (Order-nr. 07341000)\*

\*Special accessories