

23 310 000 GRANDERA BASIN MIXER 1/2" M-SIZE

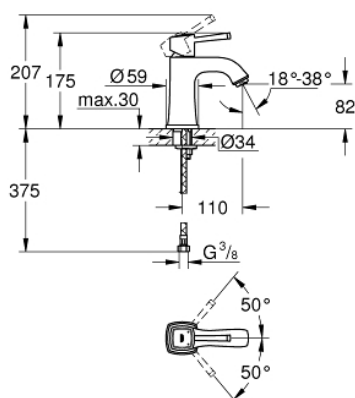

PRODUCT DESCRIPTION

- Colour: chrome
- monobloc installation
- 28 mm ceramic cartridge with GROHE SilkMove
- temperature limiter
- GROHE Long-Life finish
- GROHE Water Saving - Less water, perfect flow
- GROHE FastFixation installation system
- GROHE AquaGuide adjustable mousseur 5.7 l/min
- smooth body
- flexible connection hoses



- min. recommended pressure 1.0 bar

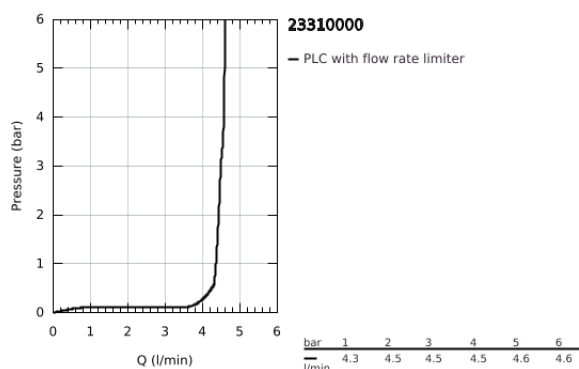

23 310 000 **GRANDERA BASIN MIXER 1/2"**
M-SIZE



SPARE PARTS, June 2012 – now

- 1: Lever (Order-nr. 46836000)
- 2: retaining ring (Order-nr. 46715000)
- 3: Cartridge (Order-nr. 46580000)
- 4: Flow straightener (Order-nr. 46837000)
- 5: Shank fastening assembly (Order-nr. 46671000)
- 6: Mounting wrench (Order-nr. 19017000)*

*Special accessories