

23 330 000 BAUEDGE BASIN MIXER 1/2" S-SIZE

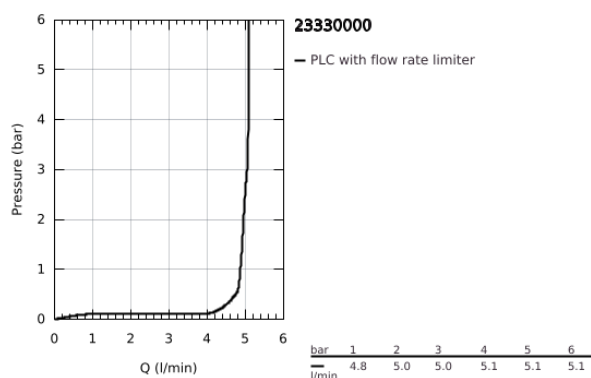

PRODUCT DESCRIPTION

- Colour: chrome
- monobloc installation
- metal lever
- GROHE Long-Life 28 mm ceramic cartridge
- GROHE Long-Life finish
- GROHE Water Saving - Less water, perfect flow
- maximum flow rate (at 3 bar): 5 l/min
- rapid installation system
- smooth body
- flexible connection hoses

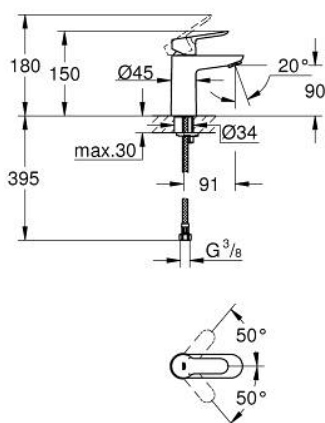

23 330 000 **BAUEDGE BASIN MIXER 1/2"**
S-SIZE



SPARE PARTS, July 2016 – now

- 1: Lever (Order-nr. 46697000)
- 2: retaining ring (Order-nr. 46715000)
- 3: Cartridge (Order-nr. 46580000)
- 4: Flow restrictor (Order-nr. 48159000)
- 5: Shank fastening assembly (Order-nr. 46249000)
- 6: Mounting wrench (Order-nr. 19017000)*

*Special accessories