

23 382 20E EURODISC COSMOPOLITAN BASIN MIXER 1/2" S-SIZE

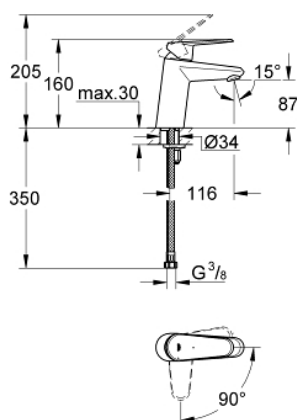

PRODUCT DESCRIPTION

- Colour: chrome
- monobloc installation
- metal lever
- GROHE SilkMove Energy Saving 35 mm ceramic cartridge with energy saving function via cold start
- adjustable flow rate limiter
- adjustable minimum flow rate 2.5 l/min
- temperature limiter
- GROHE Long-Life finish
- GROHE Water Saving - Less water, perfect flow
- maximum flow rate (at 3 bar): 5 l/min
- GROHE FastFixation installation system with centering support
- smooth body
- flexible connection hoses
- min. recommended pressure 1.0 bar

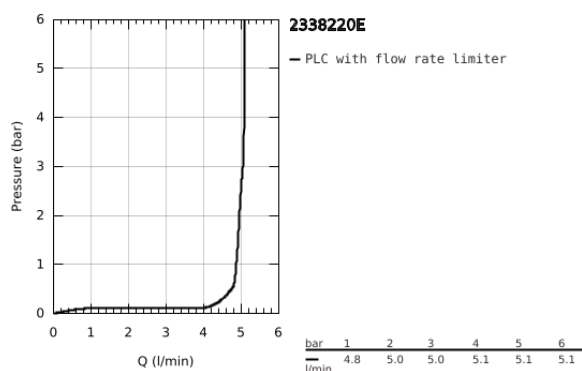

23 382 20E **EURODISC COSMOPOLITAN BASIN MIXER 1/2"**
S-SIZE

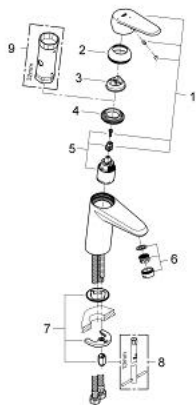

SPARE PARTS, October 2012 – now

- 1: Lever (Order-nr. 46864000)
- 2: Shield for cross handle (Order-nr. 46492000)
- 3: Temperature limiter (Order-nr. 46375000)
- 4: Screw coupling (Order-nr. 46460000)
- 5: Cartridge (Order-nr. 46863000)
- 6: Flow straightener (Order-nr. 64450000)
- 7: Shank fastening assembly (Order-nr. 46645000)
- 8: Mounting wrench (Order-nr. 19017000)*
- 9: Socket spanner (Order-nr. 19332000)*

*Special accessories