

23 389 20E EURODISC COSMOPOLITAN BASIN MIXER 1/2" S-SIZE

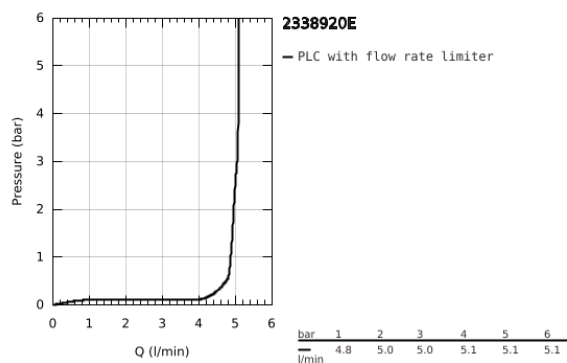
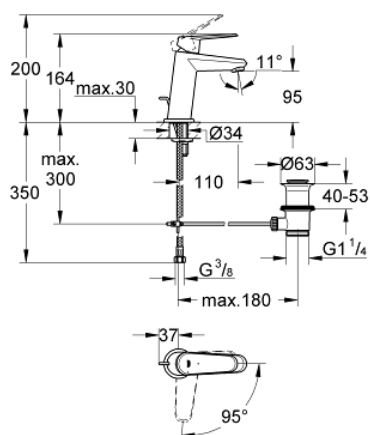

PRODUCT DESCRIPTION

- Colour: chrome
- monobloc installation
- metal lever
- GROHE SilkMove Energy Saving 28 mm ceramic cartridge with energy saving function via cold start
- with temperature limiter
- GROHE Long-Life finish
- GROHE Water Saving - Less water, perfect flow
- maximum flow rate (at 3 bar): 5 l/min
- GROHE FastFixation Plus rapid installation system
- pop-up waste set 1 1/4"
- flexible connection hoses
- min. recommended pressure 1.0 bar

23 389 20E EURODISC COSMOPOLITAN BASIN MIXER 1/2" S-SIZE

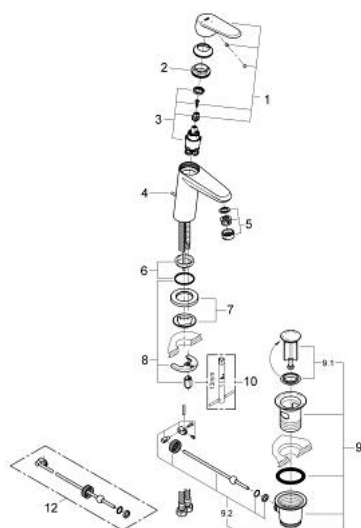

SPARE PARTS, December 2012 – now

- 1: Lever (Order-nr. 46867000)
- 2: retaining ring (Order-nr. 46715000)
- 3: Cartridge (Order-nr. 46580000)
- 4: Pop-up rod (Order-nr. 46739000)
- 5: Flow straightener (Order-nr. 64450000)
- 6: Center ring (Order-nr. 46719000)
- 7: Base plate (Order-nr. 48165000)
- 8: Shank fastening assembly (Order-nr. 46645000)
- 9: Pop-up waste set 1 1/4" (Order-nr. 28910000)
- 9.1: Chrome bath plug (Order-nr. 07182000)
- 9.2: Eccentric rod (Order-nr. 07052000)
- 10: Mounting wrench (Order-nr. 19017000)*
- 11: Eccentric rod (Order-nr. 07341000)*

*Special accessories