

23 590 DC1 ESSENCE BASIN MIXER 1/2" S-SIZE

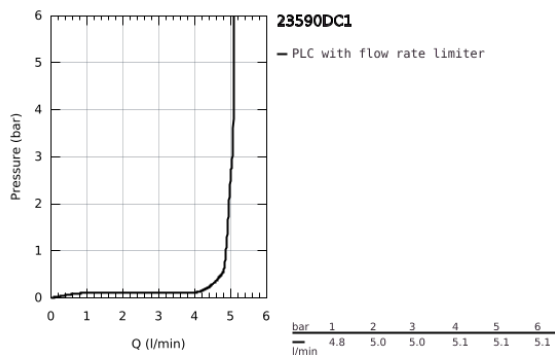

PRODUCT DESCRIPTION

- Colour: supersteel
- monobloc installation
- metal lever
- 28 mm ceramic cartridge with GROHE SilkMove
- with temperature limiter
- GROHE Long-Life finish
- GROHE Water Saving mousseur 5.7 l/min
- GROHE AquaGuide adjustable mousseur
- GROHE FastFixation Plus installation system
- smooth body
- flexible connection hoses

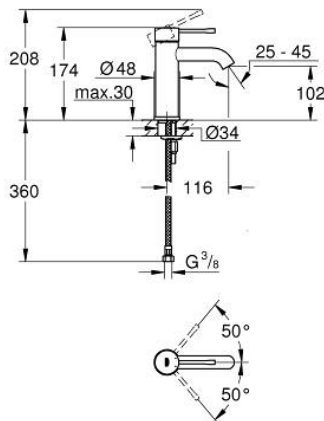

23 590 DC1 **ESSENCE BASIN MIXER 1/2"**
S-SIZE



SPARE PARTS, January 2016 – now

- 1: Lever (Order-nr. 46917DC0)
- 2: retaining ring (Order-nr. 46715000)
- 3: Cartridge (Order-nr. 46580000)
- 4: Spray plate (Order-nr. 48270000)
- 5: Shank fastening assembly (Order-nr. 46645000)
- 6: Mounting wrench (Order-nr. 19017000)*

*Special accessories