

## 26 075 AL0 EUPHORIA SYSTEM 310 SHOWER SYSTEM WITH THERMOSTATIC MIXER FOR WALL MOUNTING

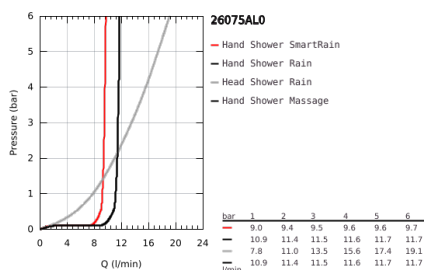
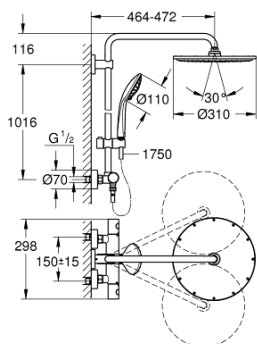

### PRODUCT DESCRIPTION

- Colour: brushed hard graphite
- consisting of:
  - horizontal swivable 450 mm projection shower arm
  - exposed thermostatic shower with Aquadimmer function
  - allows change between:
    - metal head shower Rainshower Cosmopolitan 310 (27 477 000)
    - Rain spray pattern
    - with ball joint
    - rotation angle  $\pm 15^\circ$
    - hand shower Euphoria 110 Massage (27 221 000)
  - 3 spray patterns:
    - Rain, Massage, SmartRain
  - adjustable height via gliding element
- Silverflex shower hose 1750 mm (28 388 000)
- GROHE TurboStat compact cartridge with wax thermoelement
- GROHE SafeStop safety button at 38°C ( calibration required )
- GROHE SafeStop Plus optional temperature limiter at 43°C included
- GROHE MetalGrip ergonomically shaped metal handles
- GROHE DreamSpray perfect spray pattern
- GROHE Long-Life finish
- GROHE SprayDimmer (Stepless flow rate reduction)
- Inner WaterGuide for a longer life
- SpeedClean anti-limescale system
- TwistStop preventing the hose from twisting
- suitable for instantaneous heaters from 18 kW/h
- minimum flow rate 7 l/min.
- optional upgrade: GROHE EasyReach tray (26 362), sold separately

## 26 075 AL0 EUPHORIA SYSTEM 310 SHOWER SYSTEM WITH THERMOSTATIC MIXER FOR WALL MOUNTING

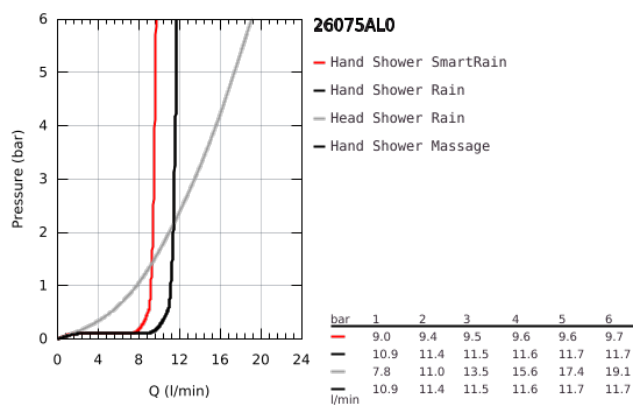

## 26 075 AL0 EUPHORIA SYSTEM 310 SHOWER SYSTEM WITH THERMOSTATIC MIXER FOR WALL MOUNTING

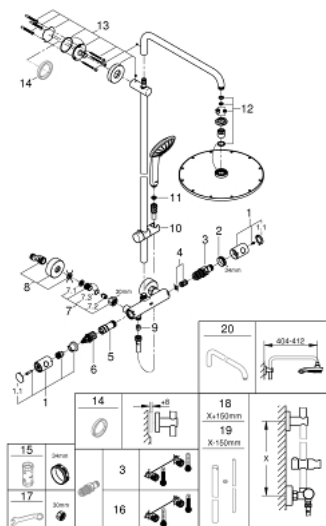

### SPARE PARTS, November 2016 – now

- 1: Metal handle 1/2" (Order-nr. 47984AL0)
- 2: retaining ring (Order-nr. 47743000)
- 3: Thermostatic compact cartridge 1/2" (Order-nr. 47439000)
- 4: Sound absorber (Order-nr. 47398000)
- 5: Water flow (Order-nr. 47751000)
- 6: Aquadimmer (Order-nr. 12433000)
- 7: Non-return valve (Order-nr. 47189AL0)
- 7.1: Dirt strainer (Order-nr. 0726400M)
- 7.2: Non-return valve (Order-nr. 08565000)
- 7.3: O-Ring Ø17 x Ø2 (Order-nr. 0305500M)
- 8: S-union (Order-nr. 12662AL0)
- 9: Non-return valve (Order-nr. 08565000)
- 10: Sliding piece (Order-nr. 12140AL0)
- 11: Strainer (Order-nr. 0700200M)
- 12: Inlet valve assembly (Order-nr. 45933000)
- 13: Outlet shower holder (Order-nr. 48279AL0)
- 15: Socket spanner (Order-nr. 19332000)\*
- 16: GROHE TurboStat cartridge 1/2" (Order-nr. 47175000)\*
- 17: Special spanner (Order-nr. 19377000)\*

\*Special accessories