

## 26 187 000 EUPHORIA SYSTEM 230 SHOWER SYSTEM WITH THERMOSTAT FOR WALL MOUNTING

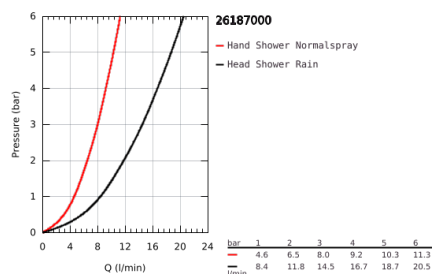

### PRODUCT DESCRIPTION

- Colour: chrome
- consisting of:
  - horizontal swivable 450 mm projection shower arm
  - exposed thermostatic shower with Aquadimmer function
  - allows change between:
    - head shower 230 (27 479 000)
    - material: metal
    - Rain spray pattern
    - with ball joint
    - rotation angle  $\pm 15^\circ$
  - hand shower Euphoria Cube Stick (27 698)
  - adjustable height via gliding element (12 140 000)
  - Silverflex shower hose 1750 mm (28 388 000)
  - GROHE TurboStat compact cartridge with wax thermoelement
  - GROHE SafeStop safety button at  $38^\circ\text{C}$  ( calibration required )
  - GROHE SafeStop Plus optional temperature limiter at  $43^\circ\text{C}$  included
  - GROHE DreamSpray perfect spray pattern
  - GROHE Long-Life finish
  - SpeedClean anti-limescale system
  - Inner WaterGuide for a longer life
  - TwistStop preventing the hose from twisting
  - GROHE MetalGrip ergonomically shaped metal handles
  - suitable for instantaneous heaters from 18 kW/h
  - minimum flow rate 7 l/min.
  - optional upgrade: GROHE EasyReach tray (26 362), sold separately

## 26 187 000 EUPHORIA SYSTEM 230 SHOWER SYSTEM WITH THERMOSTAT FOR WALL MOUNTING

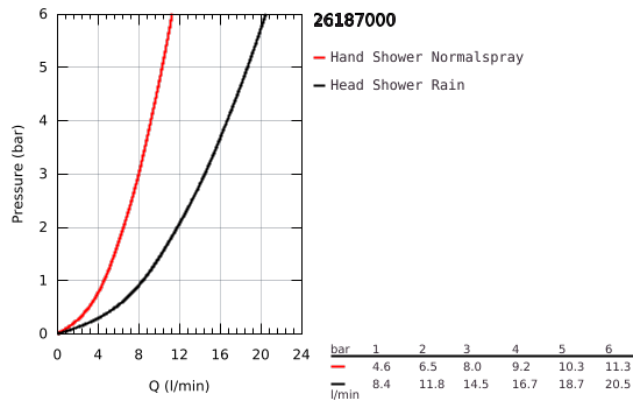

## 26 187 000 EUPHORIA SYSTEM 230 SHOWER SYSTEM WITH THERMOSTAT FOR WALL MOUNTING

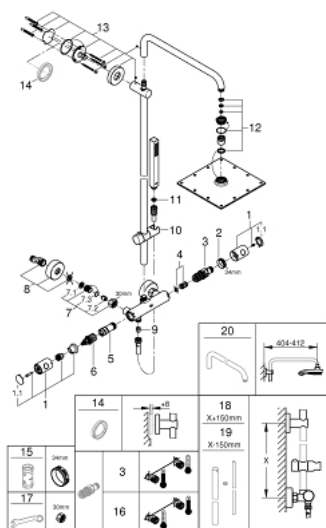

### SPARE PARTS, July 2017 – now

- 1: Metal handle 1/2" (Order-nr. 47984000)
  - 1.1: Cover Cap (Order-nr. 6458500M)
  - 2: retaining ring (Order-nr. 47743000)
  - 3: Thermostatic compact cartridge 1/2" (Order-nr. 47439000)
  - 4: Sound absorber (Order-nr. 47398000)
  - 5: Water flow (Order-nr. 47751000)
  - 6: Aquadimmer (Order-nr. 12433000)
  - 7: Non-return valve (Order-nr. 47189000)
  - 7.1: Dirt strainer (Order-nr. 0726400M)
  - 7.2: Non-return valve (Order-nr. 08565000)
  - 7.3: O-Ring Ø17 x Ø2 (Order-nr. 0305500M)
  - 8: S-union (Order-nr. 12662000)
  - 9: Non-return valve (Order-nr. 08565000)
  - 10: Sliding piece (Order-nr. 12140000)
  - 11: Strainer (Order-nr. 0700200M)
  - 12: Inlet valve assembly (Order-nr. 48471000)
  - 13: Outlet shower holder (Order-nr. 48279000)
  - 14: Spacer (Order-nr. 27180000)\*
  - 15: Socket spanner (Order-nr. 19332000)\*
  - 16: GROHE TurboStat cartridge 1/2" (Order-nr. 47175000)\*
  - 17: Special spanner (Order-nr. 19377000)\*
  - 18: Shower system pipe for retrofitting (Order-nr. 48053000)\*
  - 19: Shower system pipe for retrofitting (Order-nr. 48054000)\*
  - 20: Shower arm for shower systems (Order-nr. 14047000)\*
- \*Special accessories