

26 250 000 RAINSHOWER SYSTEM SMARTCONTROL DUO 360 SHOWER SYSTEM WITH THERMOSTAT FOR WALL MOUNTING

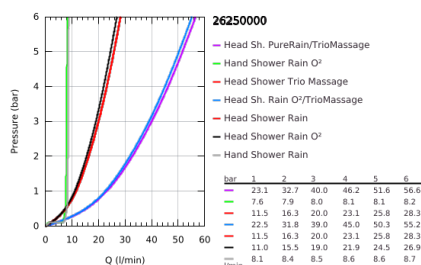

PRODUCT DESCRIPTION

- Colour: chrome
- consisting of:
 - horizontal 500 mm shower arm
 - exposed SmartControl thermostat
 - allows change between:
 - head shower Rainshower Duo 360, spray plate chrome
 - GROHE PureRain/GROHE Rain O2 spray* and TrioMassage
 - hand shower Power&Soul 115, spray plate white (27 671)
 - hand shower wall holder (27 055)
 - Silverflex shower hose 1750 mm 1/2" x 1/2" (28 388 000)
- min. recommended pressure 1.5 bar
- GROHE DreamSpray perfect spray pattern
- GROHE Long-Life finish
- GROHE CoolTouch prevents scalding on hot surfaces
- GROHE TurboStat compact cartridge with wax thermoelement
- GROHE Water Saving - Less water, perfect flow
- GROHE SafeStop safety button at 38°C (calibration required)
- GROHE SafeStop Plus optional temperature limiter at 43°C included
- GROHE SmartControl push for ON-OFF, turn for volume adjustment from GROHE Water Saving to Full Flow
- GROHE EasyReach shower tray
- SpeedClean anti-limescale system
- Inner WaterGuide for a longer life
- suitable for instantaneous heaters from 18 kW/h
- TwistStop preventing the hose from twisting
- * to be decided during initial installation; factory default setting: GROHE PureRain

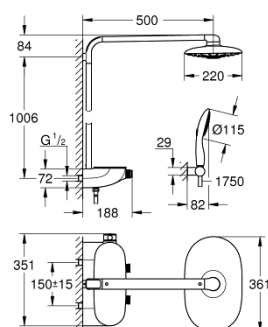

26 250 000 RAINSHOWER SYSTEM SMARTCONTROL DUO 360 SHOWER SYSTEM WITH THERMOSTAT FOR WALL MOUNTING



SPARE PARTS, October 2018 – now

- 1: Thermostatic compact cartridge 1/2" (Order-nr. 47439000)
- 2: Cartridge (Order-nr. 48297000)
- 3: Non-return valve (Order-nr. 4901000M)
- 4: Non-return valve (Order-nr. 08565000)
- 5: Strainer (Order-nr. 0700200M)
- 6: Spray face (Order-nr. 48348000)
- 7: Cover (Order-nr. 48482000)
- 8: Socket spanner (Order-nr. 49059000)*
- 9: GROHE TurboStat cartridge 1/2" (Order-nr. 47175000)*
- 10: Spacer (Order-nr. 26385000)*
- 11: Shower system pipe for retrofitting (Order-nr. 48349000)*
- 12: Shower system pipe for retrofitting (Order-nr. 48350000)*

*Special accessories