

## 26 675 001 TEMPESTA SYSTEM 250 FLEX SHOWER SYSTEM WITH DIVERTER FOR WALL MOUNTING

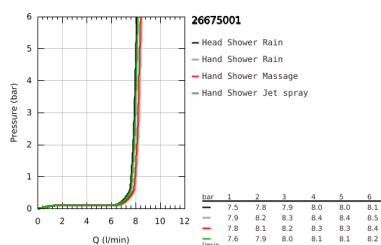
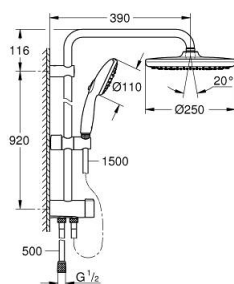
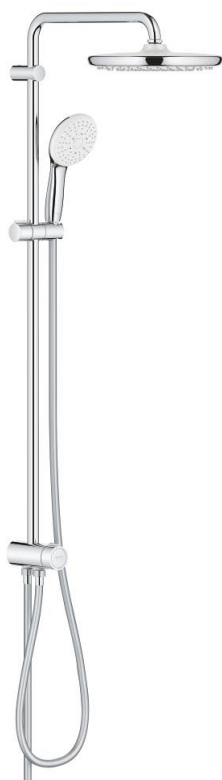

### PRODUCT DESCRIPTION (1/2)

- Colour: chrome
- consisting of:
  - horizontal 390 mm shower arm, adjustable before installation
  - change by diverter between hand shower, head shower or head shower Eco setting
  - head shower Tempesta 250 (26 666)
  - 2 spray patterns (via diverter):
    - Rain, SmartRain
  - head shower with white rear cover
  - with ball joint
  - rotation angle  $\pm 10^\circ$
  - hand shower Tempesta 110 (28 419)
  - 3 spray patterns:
    - Rain, Jet, Massage
  - adjustable height via gliding element
  - distance between diverter and upper bracket: 920 mm
  - shower hose Relexaflex 1500 mm (28 151)
  - Relexaflex shower hose 500 mm (22 115)
  - flexible installation: connection to faucet / wall union for water supply with 1/2" thread of the 500 mm shower hose
  - maximum flow rate (at 3 bar): 7.9 l/min
  - GROHE Water Saving - Less water, perfect flow
  - GROHE SmartSwitch - easily rotate the dial to enjoy your preferred spray option
  - GROHE DreamSpray perfect spray pattern
  - ShockProof silicone ring prevents damage caused by a shower falling
  - GROHE Long-Life finish
  - SpeedClean anti-limescale system
  - Inner WaterGuide for a longer life
  - suitable for instantaneous heaters from 18 kW/h
  - minimum flow rate 7 l/min.

Pure Freude  
an Wasser



## 26 675 001 **TEMPESTA SYSTEM 250 FLEX SHOWER SYSTEM WITH DIVERTER FOR WALL MOUNTING**

### PRODUCT DESCRIPTION (2/2)

- min. recommended pressure 1.0 bar
- professional edition

## 26 675 001 TEMPESTA SYSTEM 250 FLEX SHOWER SYSTEM WITH DIVERTER FOR WALL MOUNTING

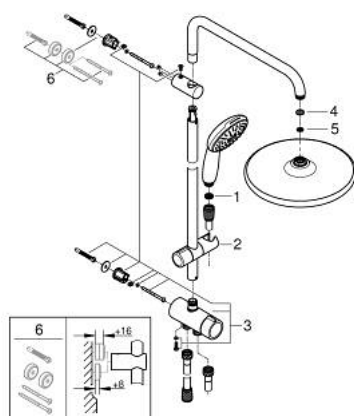

### SPARE PARTS, November 2021 – now

- 1: Strainer (Order-nr. 0700200M)
  - 2: Sliding piece (Order-nr. 48609000)
  - 3: Diverter (Order-nr. 48338000)
  - 4: Fibre seal dia. Ø 18,5 x Ø 12 x 2 (Order-nr. 0138900M)
  - 5: Strainer (Order-nr. 48007000)
  - 6: Spacer (Order-nr. 26496000)\*
- \*Special accessories