

## 26 818 001 TEMPESTA SYSTEM 250 SHOWER SYSTEM WITH THERMOSTAT 160 CC FOR WALL MOUNTING

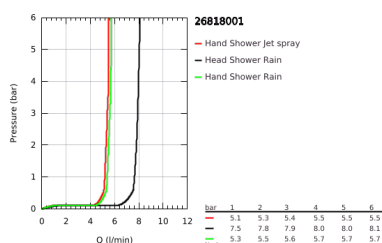

### PRODUCT DESCRIPTION (1/2)

- Colour: chrome
- consisting of:
  - horizontal swivable 390 mm projection shower arm
  - exposed thermostatic shower with Aquadimmer function
  - centre distance 160 mm
- allows change between:
  - head shower Tempesta 250 (26 666)
  - spray pattern:
    - Rain
  - head shower with white rear cover
  - with ball joint
  - rotation angle  $\pm 10^\circ$
- hand shower Tempesta 110 (27 597)
- 2 spray patterns:
  - Rain, Jet
- adjustable height via gliding element
- RotaflexTwistStop shower hose 1750 mm 1/2" x 1/2" (28 410)
- maximum flow rate (at 3 bar): 8.5 l/min
- GROHE Water Saving - Less water, perfect flow
- GROHE TurboStat compact cartridge with wax thermoelement
- GROHE SafeStop safety button at 38°C (calibration required)
- GROHE SafeStop Plus optional temperature limiter at 43°C included
- GROHE SmartSwitch - easily rotate the dial to enjoy your preferred spray option
- GROHE DreamSpray perfect spray pattern
- GROHE FastFixation upper bracket, +40 / -100 mm height adjustable and up to 36 mm depth adjustable
- ShockProof silicone ring prevents damage caused by a shower falling
- GROHE Long-Life finish
- SpeedClean anti-limescale system
- Inner WaterGuide for a longer life
- TwistStop preventing the hose from twisting
- suitable for instantaneous heaters from 18 kW/h

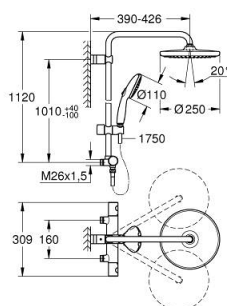

## 26 818 001 **TEMPESTA SYSTEM 250 SHOWER SYSTEM WITH THERMOSTAT 160 CC FOR WALL MOUNTING**

### **PRODUCT DESCRIPTION** (2/2)

- minimum flow rate 7 l/min.
- integrated flow elements for improved performance with higher pressure differences between hot and cold water supply
- professional edition
- maximum flow rate (at 3 bar): 7.3 l/min



## 26 818 001 TEMPESTA SYSTEM 250 SHOWER SYSTEM WITH THERMOSTAT 160 CC FOR WALL MOUNTING

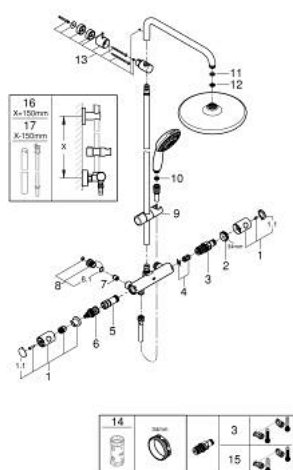

### SPARE PARTS, November 2021 – now

- 1: Metal handle 1/2" (Order-nr. 47984000)
- 1.1: Cover Cap (Order-nr. 6458500M)
- 2: retaining ring (Order-nr. 47743000)
- 3: Thermostatic compact cartridge 1/2" (Order-nr. 47439000)
- 4: Sound absorber (Order-nr. 47398000)
- 5: Water flow (Order-nr. 47751000)
- 6: Aquadimmer (Order-nr. 12433000)
- 7: Non-return valve (Order-nr. 48224000)
- 8: union connection (Order-nr. 48599000)
- 8.1: O-Ring Ø17 x Ø2 (Order-nr. 0305500M)
- 9: Sliding piece (Order-nr. 48609000)
- 10: Strainer (Order-nr. 0700200M)
- 11: Fibre seal dia. Ø 18,5 x Ø 12 x 2 (Order-nr. 0138900M)
- 12: Strainer (Order-nr. 48007000)
- 13: Outlet shower holder (Order-nr. 48619000)
- 14: Socket spanner (Order-nr. 19332000)\*
- 15: GROHE TurboStat cartridge 1/2" (Order-nr. 47175000)\*
- 16: Shower system pipe for retrofitting (Order-nr. 48514000)\*
- 17: Shower system pipe for retrofitting (Order-nr. 48515000)\*

\*Special accessories