

## 30 312 DC0 K7 FOOT CONTROL ELECTRONIC SINGLE-LEVER SINK MIXER 1/2"



### PRODUCT DESCRIPTION

- Colour: supersteel
- medium spout
- Foot control: activation of water via contact with sensor
- battery supply 6 V lithium-battery, type CR-P2
- CE approved
- solenoid valve
- fixed value mixing valve
- automatically stops after 60 sec. (factory set)
- type of protection IP 44
- GROHE SilkMove 35 mm ceramic cartridge
- professional spray
- diverter: mousseur/shower jet
- automatic return to mousseur
- adjustable flow rate limiter
- swivel tubular spout
- swivel area 360°
- protected against backflow
- flexible connection hoses
- rapid installation system



## 30 312 DC0 K7 FOOT CONTROL ELECTRONIC SINGLE-LEVER SINK MIXER 1/2"

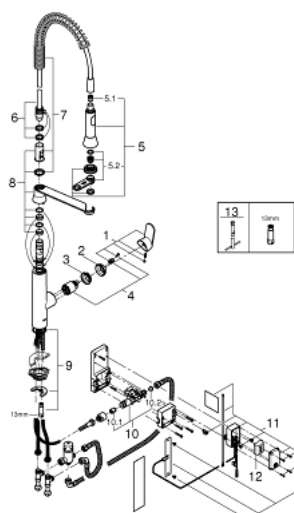

### SPARE PARTS, July 2015 – now

- 1: Lever (Order-nr. 46927DC0)
  - 2: Shield for cross handle (Order-nr. 46116DC0)
  - 3: Screw coupling (Order-nr. 46460000)
  - 4: Cartridge (Order-nr. 46374000)
  - 5: Hand shower (Order-nr. 46731DC0)
  - 5.1: Non-return valve (Order-nr. 08565000)
  - 5.2: Flow restrictor (Order-nr. 46711000)
  - 6: Shower hose (Order-nr. 46871DC0)
  - 7: Spring (Order-nr. 46873SD0)
  - 8: Holder pull out spray (Order-nr. 46734DC0)
  - 9: Shank fastening assembly (Order-nr. 46671000)
  - 10: Solenoid valve (Order-nr. 48213000)
  - 10.1: Non-return valve (Order-nr. 08565000)
  - 10.2: Strainer (Order-nr. 42395000)
  - 11: Control unit (Order-nr. 48304000)
  - 12: Battery (Order-nr. 42886000)
  - 13: Mounting wrench (Order-nr. 19017000)\*
- \*Special accessories