

32 168 DC0 MINTA SINGLE-LEVER SINK MIXER 1/2"

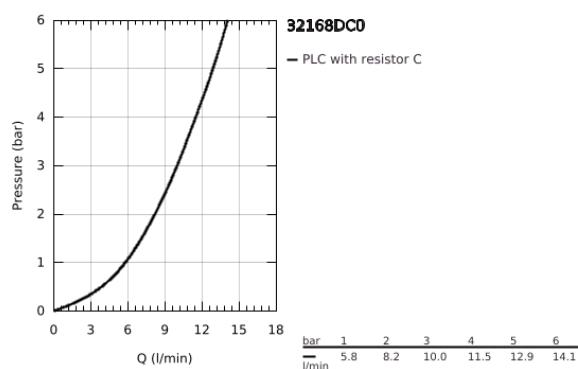

PRODUCT DESCRIPTION

- Colour: supersteel
- L-spout
- monobloc installation
- GROHE Long-Life finish
- GROHE SilkMove 46 mm ceramic cartridge
- pull out mousseur spout
- adjustable flow rate limiter
- swivel tubular spout
- swivel area 360°
- integrated non-return valve
- protected against backflow
- flexible connection hoses
- rapid installation system
- maximum flow rate (at 3 bar): 10 l/min

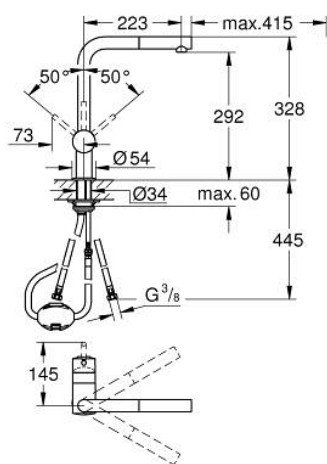

32 168 DC0 MINTA SINGLE-LEVER SINK MIXER 1/2"

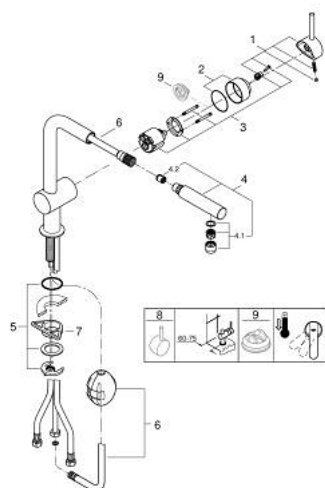

SPARE PARTS, April 2024 – now

- 1: Lever (Order-nr. 46015DC0)
- 2: Shield for cross handle (Order-nr. 46025DC0)
- 3: Cartridge (Order-nr. 46048000)
- 4: Hand shower (Order-nr. 46858DC0)
- 4.1: Non-return valve (Order-nr. 08565000)
- 4.2: Flow restrictor (Order-nr. 13967DC0)
- 5: Shank fastening assembly (Order-nr. 46345000)
- 6: Hose for sink mixer with pull-out dual spray or mousseur (Order-nr. 48293000)
- 7: Support plate (Order-nr. 05334000)
- 8: Temperature limiter (Order-nr. 46375000)*
- *Special accessories