

32 839 000 EUROSMART COSMOPOLITAN BIDET MIXER 1/2" S-SIZE

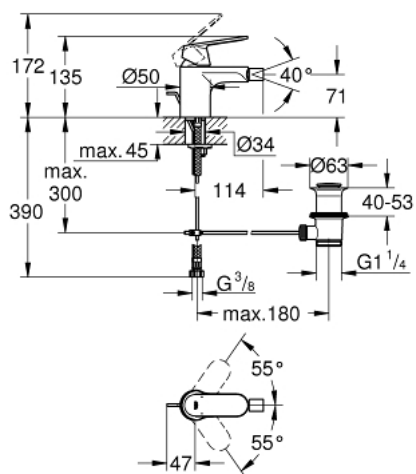

PRODUCT DESCRIPTION

- Colour: chrome
- monobloc installation
- metal lever
- GROHE SilkMove 35 mm ceramic cartridge
- adjustable flow rate limiter
- GROHE Long-Life finish
- GROHE Water Saving - Less water, perfect flow
- maximum flow rate (at 3 bar): 5 l/min
- GROHE FastFixation installation system with centering support
- ball-joint mousseur
- pop-up waste set 1 1/4"
- flexible connection hoses
- optional temperature limiter (46 375 000)
- noise classification 1 in accordance with DIN4109

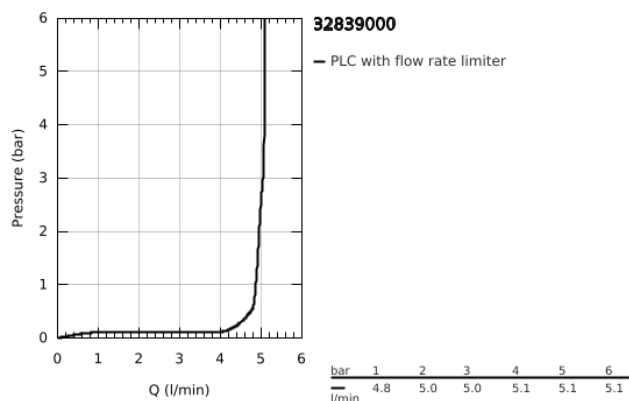

32 839 000 EUROSMART COSMOPOLITAN BIDET MIXER 1/2" S-SIZE

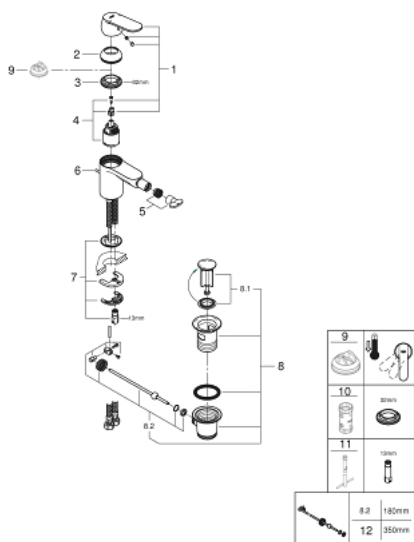

SPARE PARTS, August 2009 – now

- 1: Lever (Order-nr. 46681000)
- 2: Shield for cross handle (Order-nr. 46492000)
- 3: Screw coupling (Order-nr. 46460000)
- 4: Cartridge (Order-nr. 46374000)
- 5: Flow restrictor (Order-nr. 13998000)
- 6: Pop-up rod (Order-nr. 46739000)
- 7: Shank fastening assembly (Order-nr. 46671000)
- 8: Pop-up waste set 1 1/4" (Order-nr. 28910000)
- 8.1: Chrome bath plug (Order-nr. 07182000)
- 8.2: Eccentric rod (Order-nr. 07052000)
- 9: Temperature limiter (Order-nr. 46375000)*
- 10: Socket spanner (Order-nr. 19332000)*
- 11: Mounting wrench (Order-nr. 19017000)*
- 12: Eccentric rod (Order-nr. 07341000)*

*Special accessories