

32 917 000 MINTA SINGLE-LEVER SINK MIXER 1/2"

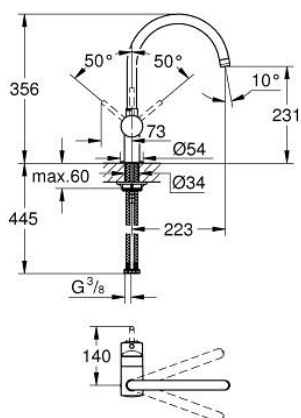

PRODUCT DESCRIPTION

- Colour: chrome
- C-spout
- monobloc installation
- GROHE Long-Life finish
- GROHE SilkMove 46 mm ceramic cartridge
- adjustable flow rate limiter
- swivel tubular spout
- selectable swivel area : 0° / 150° / 360°
- flexible connection hoses
- with compression nut
- rapid installation system
- optional temperature limiter ref. no. 46 308
- maximum flow rate (at 3 bar): 11.5 l/min

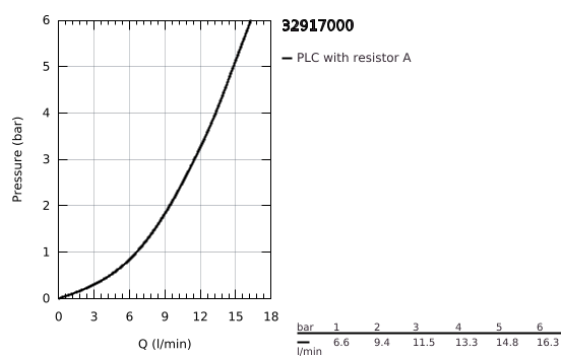

32 917 000 **MINTA SINGLE-LEVER SINK MIXER 1/2"**

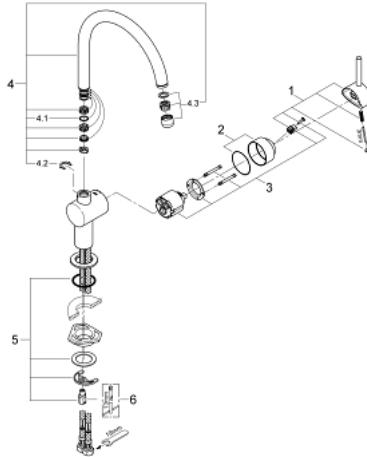

SPARE PARTS, March 2007 – now

- 1: Lever (Order-nr. 46015000)
- 2: Shield for cross handle (Order-nr. 46025000)
- 3: Cartridge (Order-nr. 46048000)
- 4: C-spout (Order-nr. 13043000)
- 4.1: Sealing washer (Order-nr. 0128500M)
- 4.2: Safety ring (Order-nr. 0485300M)
- 4.3: Flow restrictor (Order-nr. 13928000)
- 5: Shank fastening assembly (Order-nr. 46249000)
- 6: Mounting wrench (Order-nr. 19017000)*

*Special accessories