

36 384 000 **EUROECO COSMOPOLITAN E POWERBOX**

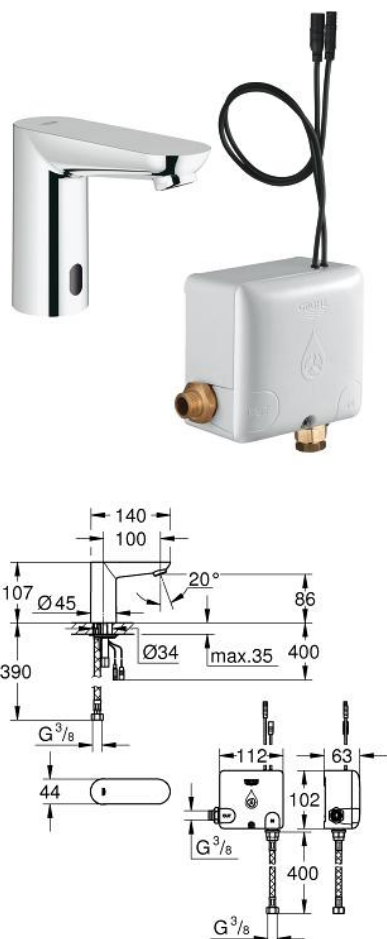

## PRODUCT DESCRIPTION

- Colour: chrome
- infra-red electronic basin tap 1/2" without mixing device
- with infrared sensor for bi-directional communication for monitoring, configuration and servicing
- including Powerbox self-generating power system
- GROHE Water Saving - Less water, perfect flow
- maximum flow rate (at 3 bar): 5 l/min
- flexible connection hose
- dirt strainer
- rapid installation system
- Powerbox
- power generator with water turbine
- internal energy saving unit
- with use of 60 s/24 h stand-by, 260 s/100 h stand-by
- with additional backup power
- 7 pre-set programs:
- auto flush
- thermal disinfection
- cleaning mode
- additional functions and precise settings by remote control 36 407
- min. recommended pressure 1.0 bar

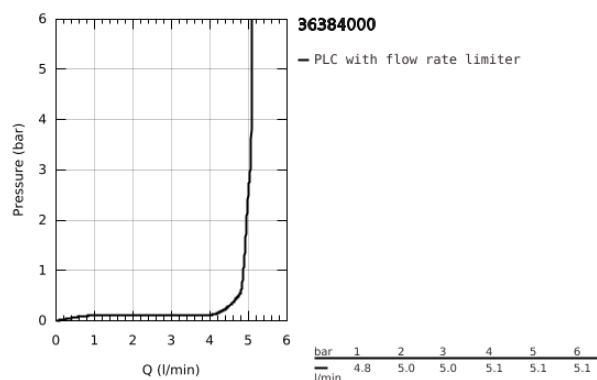

## 36 384 000 EUROECO COSMOPOLITAN E POWERBOX

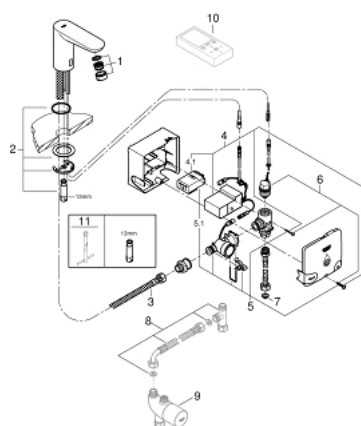

### SPARE PARTS, August 2016 – now

- 1: Flow restrictor (Order-nr. 48159000)
- 2: Shank fastening assembly (Order-nr. 42389000)
- 3: Connection hose (Order-nr. 46255000)
- 4: Electronic (Order-nr. 42458000)
- 4.1: Battery housing (Order-nr. 42393000)
- 5: Generator (Order-nr. 42457000)
- 5.1: Battery housing (Order-nr. 42393000)
- 6: Solenoid valve (Order-nr. 42456000)
- 7: Filter (Order-nr. 4241300M)
- 8: Connection set (Order-nr. 47533000)\*
- 9: Thermostatic scalding protection (Order-nr. 34487000)\*
- 10: Remote control (Order-nr. 36407001)\*
- 11: Mounting wrench (Order-nr. 19017000)\*

\*Special accessories