

36 439 000 **EUROSMART COSMOPOLITAN E INFRA-RED ELECTRONIC BASIN TAP 1/2"**

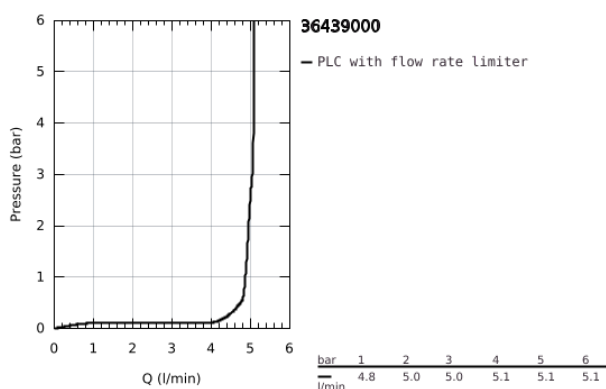
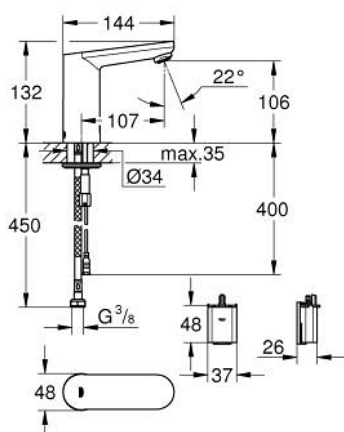

PRODUCT DESCRIPTION

- Colour: chrome
- with infrared sensor for bi-directional communication for monitoring, configuration and servicing
- for cold or premixed water
- 6V lithium battery, type CR-P2
- battery lifetime: approx. 7 years (150 actuations a day)
- GROHE Long-Life finish
- GROHE Water Saving mousseur 5.7 l/min
- flexible connection hose
- dirt strainer
- with integrated solenoid valve
- external battery
- rapid installation system
- multistage battery status display
- 7 pre-set programs:
- auto flush
- thermal disinfection
- cleaning mode
- additional functions and precise settings by remote control 36 407
- CE approved
- noise classification 1 in accordance with DIN4109
- type of protection faucet IP 59K
- min. recommended pressure 1.0 bar

36 439 000 **EUROSMART COSMOPOLITAN E INFRA-RED ELECTRONIC BASIN TAP 1/2"**

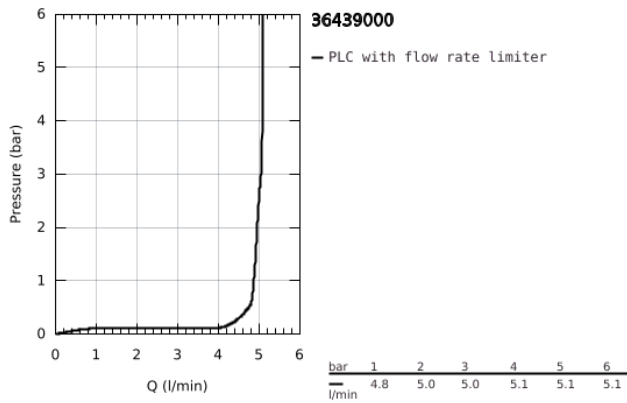

36 439 000 EUROSMART COSMOPOLITAN E INFRA-RED ELECTRONIC BASIN TAP 1/2"

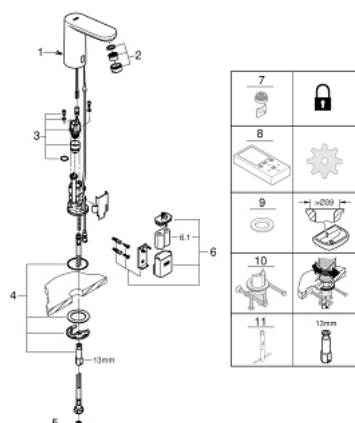

SPARE PARTS, June 2016 – now

- 1: Pop-up rod (Order-nr. 46739000)
- 2: Flow restrictor (Order-nr. 48159000)
- 3: Solenoid valve (Order-nr. 42479000)
- 4: Mounting set (Order-nr. 42400000)
- 5: Filter (Order-nr. 4241300M)
- 6: Battery housing (Order-nr. 42393000)
- 6.1: Battery (Order-nr. 42886000)
- 7: Flow restrictor (Order-nr. 36133000)*
- 8: Remote control (Order-nr. 36407001)*
- 9: Escutcheon (Order-nr. 36370000)*
- 10: Rotation lock (Order-nr. 36276000)*
- 11: Mounting wrench (Order-nr. 19017000)*

*Special accessories