

38 785 000 UNISET ELEMENT FOR URINAL WITH INFRA-RED ELECTRONIC

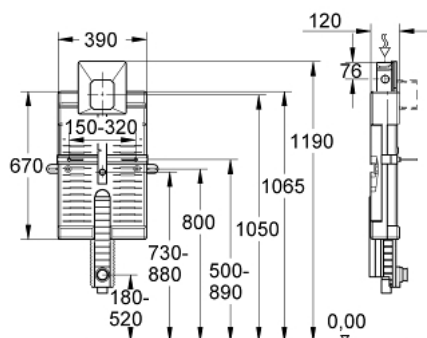

PRODUCT DESCRIPTION

- with GROHE Rapido U
- roughing-in set for urinal
- for manual actuation or Tectroninfra-red electronic 6 V or 230 V
- sound-insulating EPS module for masonry-in with closed surface
- rail adaptors for modular fixing
- for single or series installation
- fixing accessories for single installation
- height adjustable fitting connections
- inlet connection and inlet connecting set
- HT-outlet bend Ø 50 mm
- threaded bolts M8
- fixing material for urinal bowl
- water group with stop valve
- flow pressure min 0.5 bar
- operating pressure max 10 bar
- flush aid
- functional unit checked ex factory
- water supply connections ½" outer thread
- connecting box for mains supply 230 V
- installation box with gasket
- inspection shaft incl. protection during construction phase



38 785 000 **UNISET ELEMENT FOR URINAL WITH INFRA-RED ELECTRONIC**

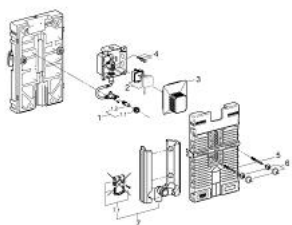

SPARE PARTS, November 2015 – now

- 1: Urinal inlet connector, 1/2" (Order-nr. 37044000)
- 1.1: Lip seal (Order-nr. 4387500M)
- 1.2: Admission Sleeve (Order-nr. 43891000)
- 2: Switching power supply (Order-nr. 42470000)
- 3: Inspection shaft (Order-nr. 66838000)
- 4: Isolating valves, pair (Order-nr. 43392000)
- 5: hreaded bolt (Order-nr. 43078000)
- 6: Fastening set (Order-nr. 4307500M)
- 7: Elbow 2" (Order-nr. 42943000)
- 7.1: holder (Order-nr. 42236000)